

Cradley Churchyard trees – work plan

Our Churchyard Plan, last modified 10 October 2017, will be found on the notice-board at www.cradley.org.uk and at www.cradleychurch.org.uk, including pictures and tree heights. This work plan refers to the Cradley Churchyard tree map (below) with urgent trees coloured in purple (for which we have Archdeacon and formal Planning consent) and others to be felled coloured red (for which we have formal Planning Permission and are now submitting the Chancellor's Faculty, permission expected before August 2018).

We urgently need to fell the potentially dangerous Silver Birch 12a and crown lift Sweet Chestnut 6 to a height of 1.7m using a contractor before the next working party of 17th March 2018. The contractor shall cut the wood into max 2-man lift-able lengths but leave it where it falls. Volunteers will fell the overhanging trunk of Beech 7 on the eastern boundary and a professional arboriculturist will advise the volunteers before work commences. Due to the proximity of graves Ash 9 by the electricity wire on the west boundary will also need to be felled by a contractor. Volunteers will clear away felled wood and brash from all these trees. Health and safety risk assessments are being carried out and authorised volunteers will be made aware of these risks.

Starting from August 2018 volunteers will fell and clear away Cypress 4b that has the form of a very large bush with no central trunk - a professional arboriculturist will advise the volunteers before work commences. We require budgetary guesstimates from contractors now for the Faculty application for the felling of:

- 10 Cypress
- 4a Cypress
- 5 Cypress
- 3b Cypress
- 3a Cypress
- 11 Cypress (two of the largest trunk sections should be cut at ~8' length and left on the top of the bank for use as seating).
- 8 Sycamore (bole to be left at hedge height)

The contractor shall fell all these trees to ground level and dispose of all branches and foliage less than ~3" diameter, larger wood being cut into 2-man lift-able lengths and left as firewood for villagers. Vehicles shall not be allowed in the Churchyard, but access nearby can be arranged via Hugh Forsyth at Stoney Villa. By August he will clear his area and the fence alongside the low wall to the east of Sweet Chestnut 6 for the contractors chipper, trailer or lorry.

As an alternative cost saving option the contractor may leave the less than 3" brash by each of the felled trees, piled as neatly as possible, for volunteers to clear or burn over the stumps. In this case all 'firewood' must be stacked as neatly as possible nearby. It may be better for the contractor to strip each tree, leave the fallen branches for volunteers to clear, and then re-visit a week or more later for the actual felling.

These trees are listed in priority order, although cost may dictate the actual order of felling. Please give guesstimates for individual trees and also the 'job lot' (both options with brash removed and brash left for burning) so we can plan funding appropriately.

The contractor shall abide by the Church Buildings Council codes of practice, in particular with work to be compliant with BS3998:2010, have appropriate indemnity insurance and risk assessment. Any damage to gravestones must be minimised; damaged or unsafe items must be identified to a Churchwarden.

Tony Copp 01886 880731, 07976 969537, Stiffords Bridge House, WR13 5NN, for Cradley PCC Churchyard Committee.

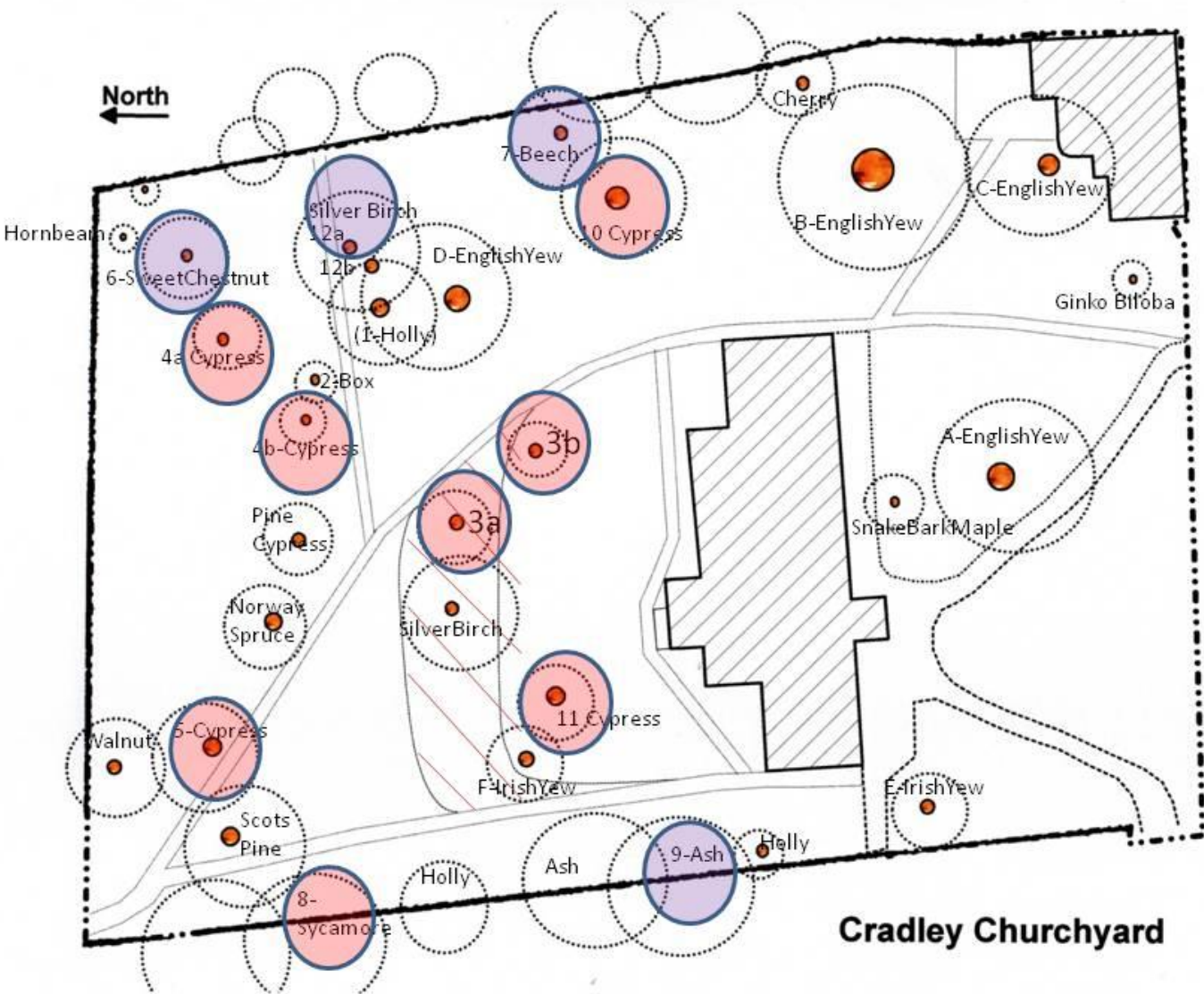

Cradley Churchyard